

RETAIL IN THE CENTER OF OF IT ALL



Boasting a dynamic office, tech, residential, and arts community, as well as an exciting dining scene, Long Island City is New York City's most talked about destination neighborhood. Conveniently located, it is the hub of multiple subway lines. Traveling into Manhattan is easy with one-stop service from the Court Square Station, less than one block away.

Become part of this growing community in LIC's Court Square with this exceptional ground-floor space geared toward smart retailers who bring something beyond the ordinary.

For more information or to view the space, please contact: Patricia Dunphy
SVP, Rockrose Development LLC
Phone: 212.847.3700 Fax: 212.757.1875
patricia.dunphy@rockrose.com
rockrose.com

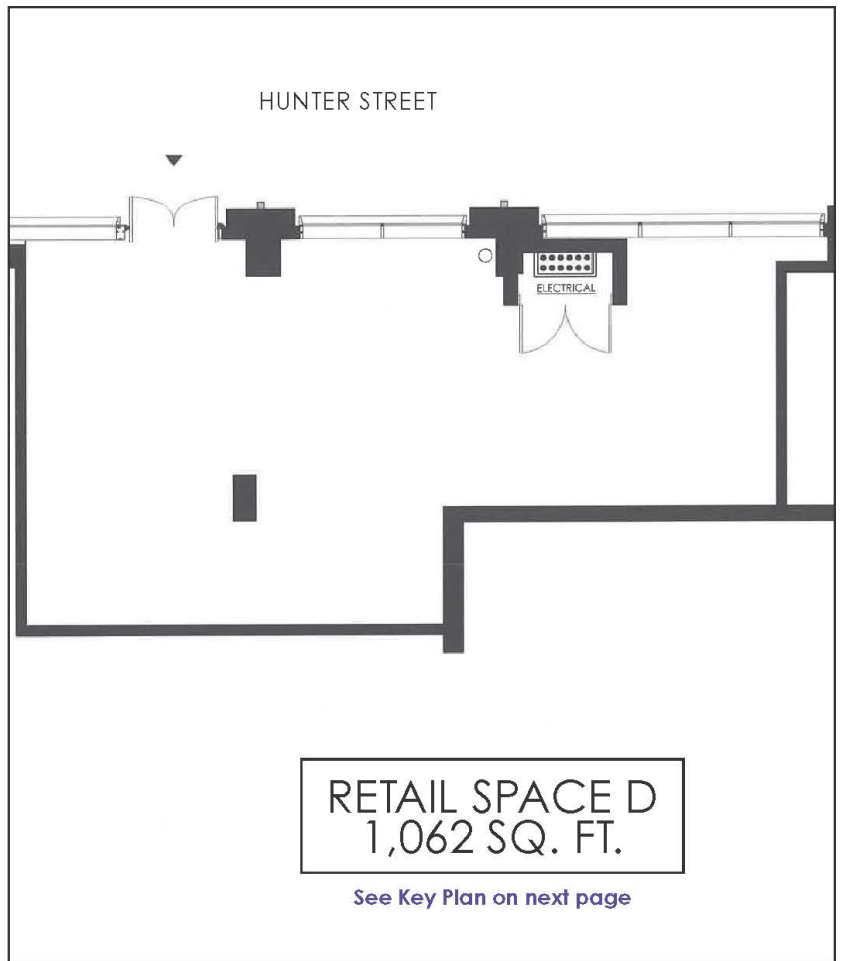

HAYDEN
LONG ISLAND CITY

ROCKROSE

GROUND FLOOR KEY PLAN

